

Instructions for Installing Recessed Lights in Beams

Materials:



Recessed Light Fixture(s)

Tools:

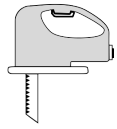

Saw with Finish Blade or Hole Saw



Pencil



Safety Glasses

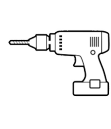

Drill



Drill Bits

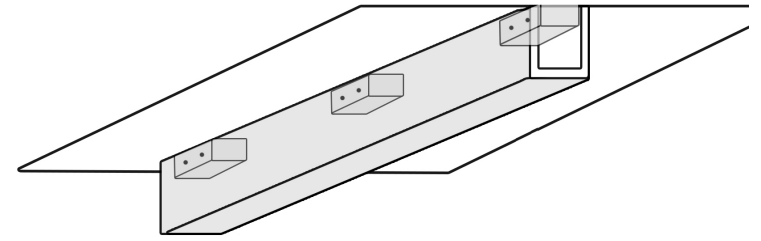

Follow local building and fire codes as well as the light manufacturer's recommended clearances.

Turn electricity off prior to starting any electrical work.

Pull all electrical prior to installing the beam and lights.

These steps need to be coupled with the steps outlined in the project-appropriate beam installation guide.

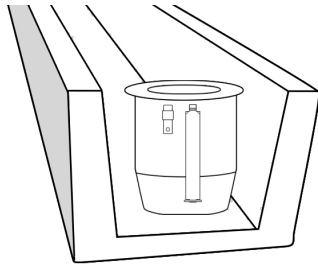

1) Measure Beam

Ensure your fixture had adequate clearance inside the beam.

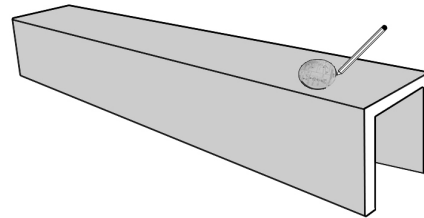

2) Mark location of the hole

Determine the location of your light. Mark the cut based on the light manufacturers instructions/ template.

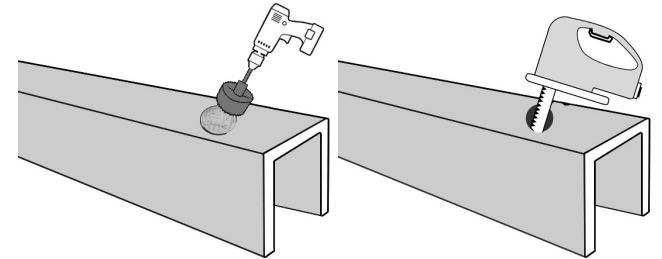

3) Cut holes

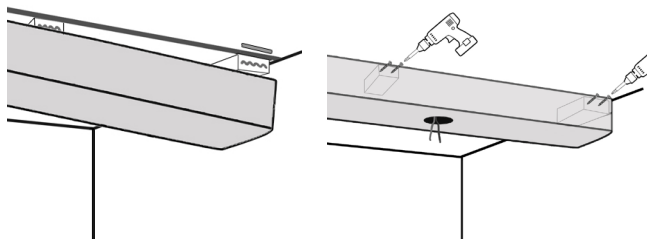

4) Install Beam

Install the beam based on the appropriate installation guide over the electrical work. Ensure that all electrical has been pulled prior to gluing and screwing the beam in place.

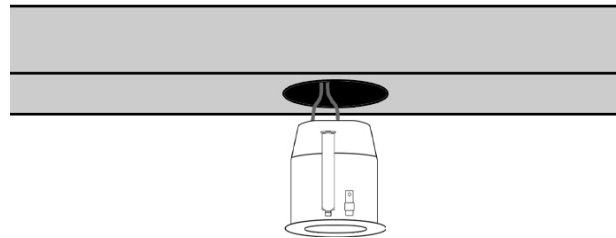

5) Connect the light fixture to the electrical supply

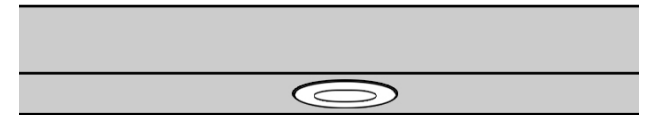

6) Insert Fixture

Insert fixture into the beam and finish according to light fixture manufacturer instructions.

Questions? Our Customer Experience & Design Support Team is here to assist you Monday-Friday from 8AM to 5PM EST at (800) 651-4223.